

2004-10-15
00:00:00

CAD: 1/17/10

1/17/10

1/17/10

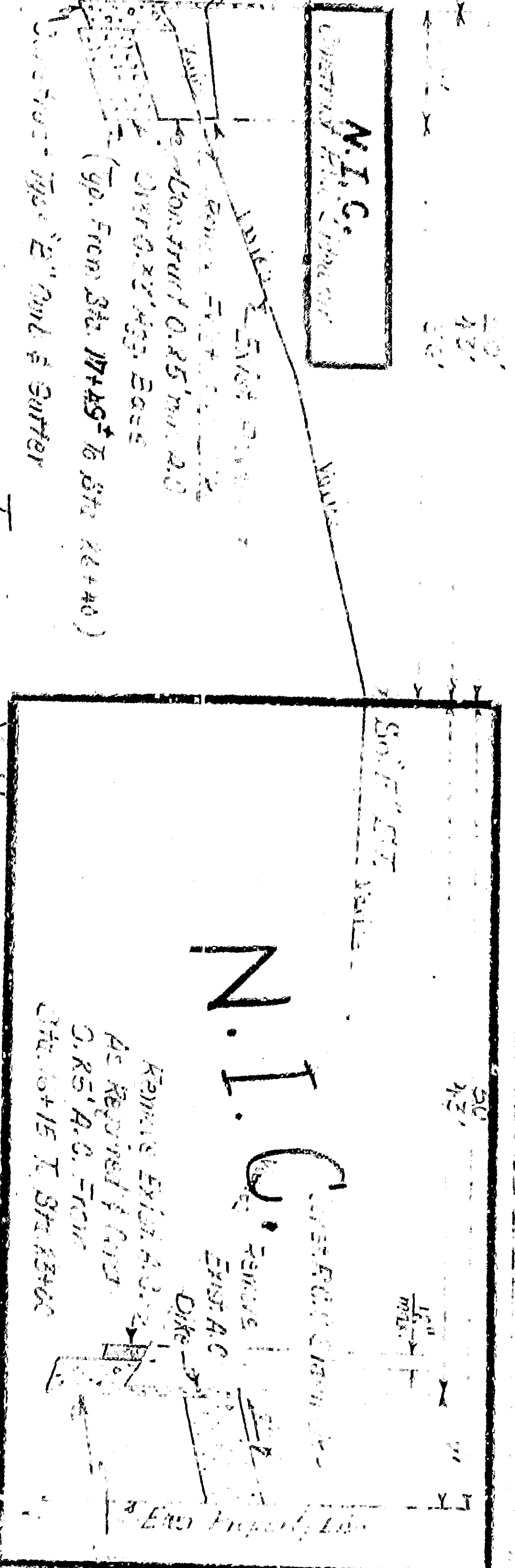


Remove Exist. Curb From Sta. 17+40 To Sta. 26+10

NOTE: End of section is with a minimum 4' clearance in the field. Width of curb is 10'.

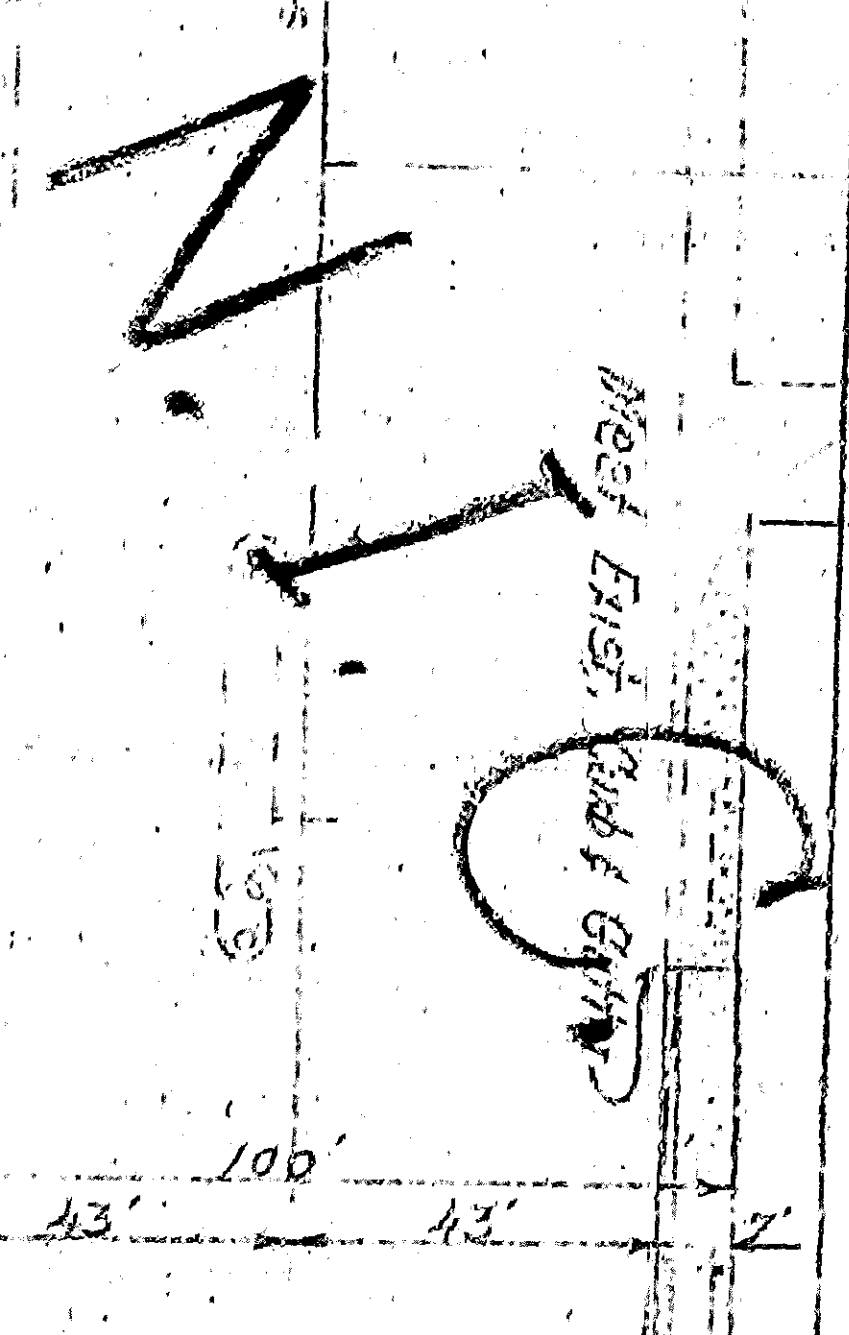

Remove Exist. Centerline & Sidewalk From Sta. 17+40 To Sta. 26+10

N.I.C.

PLAN

Scale: 1" = 40'

Sheet 1 of 1

APPROVED: [Signature]

REGISTERED CIVIL ENGINEER, 18653

DRAWING NO. 3575A

DESIGNED BY: [Signature]

CHECKED BY: [Signature]

DATE: 1/17/10

CITY OF SAN BERNARDINO

CURB, GUTTER AND PAVING

SOUTH "E" STREET

ATLAS TREATMENT CO. FRONTAGE

NOTE: N.I.C. = NOT IN CONTRACT